

## Encoder Kit L2

### Components for Linear Measurement

- Dynamic offset and amplitude control
- Signal interpolation up to 100x

## Features

- Compact design for limited installation space
- Modular design
- Customer specific connector possible
- Dynamic offset and amplitude control
- Reduced interpolation error
- Increased insensitivity to scale tape pollution
- Signal interpolation up to 100x
- Resolution down to 50 nm
- Traversing speed up to 10 m/s

## Ordering key

- Ordering key analog to previous Kit L
- Sensor type 2:  
Double field sensor 20 x 8,  
Adjustable sensor amplifier
- Example: Kit L 221BA P4

## Available frames for measuring modules

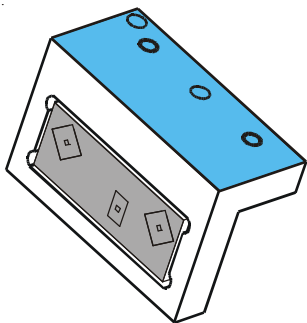

Frame B

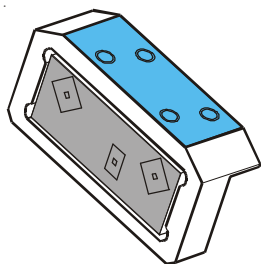

Frame C

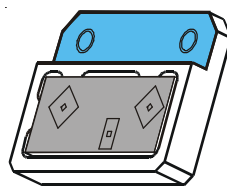

Frame P/M

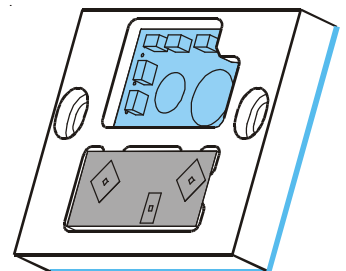

Frame S



**NUMERIK JENA GmbH**

Ilmstraße 4  
D-07743 Jena  
Germany

Phone ++49 3641 47 28 21  
Fax ++49 3641 47 28 20  
E-mail [info@numerikjena.de](mailto:info@numerikjena.de)  
Internet [www.numerikjena.de](http://www.numerikjena.de)

05/2003